

## REMOVAL AND INSTALLATION

### Strut and Spring Assembly

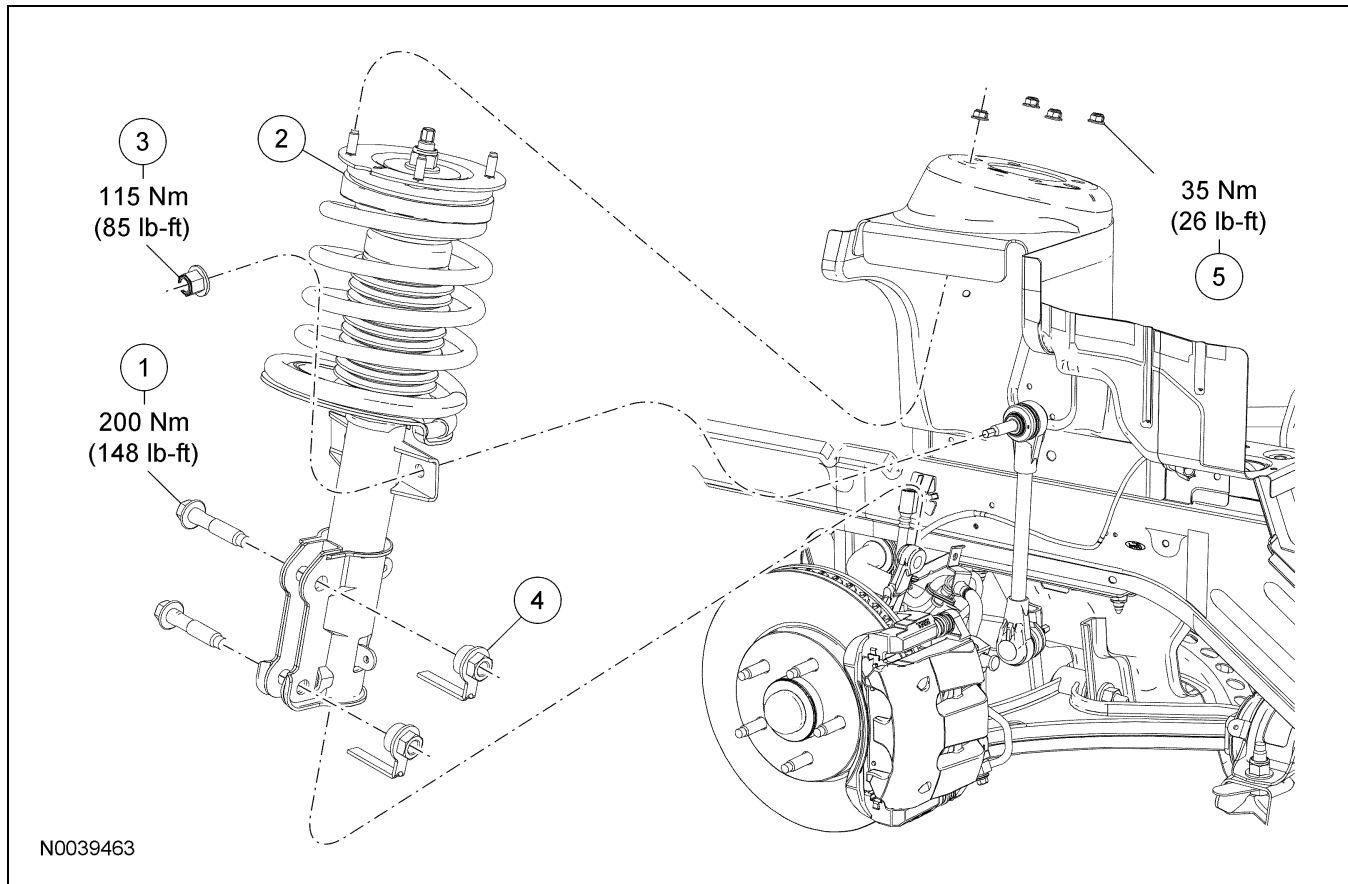

Item	Part Number	Description
1	W709870	Strut-to-wheel spindle bolt (2 required)
2	—	Strut and spring assembly
3	N807144	Stabilizer bar link upper nut
4	W711091	Strut-to-wheel spindle flag nut (2 required)
5	W520112	Strut upper mount nut (4 required)

#### Removal and Installation

**⚠ WARNING:** All vehicles are equipped with gas-pressurized struts which will extend unassisted. Do not apply heat or flame to the struts during removal or component servicing. Failure to follow these instructions can result in personal injury.

**⚠ CAUTION:** Suspension fasteners are critical parts because they affect performance of vital components and systems and their failure can result in major service expense. A new part with the same part number or an equivalent part must be installed, if installation is necessary. Do not use a part of lesser quality or substitute design. Torque values must be used as specified during reassembly to make sure of correct retention of these parts.

- Remove the 4 strut upper mount nuts.
  - To install, tighten to 35 Nm (26 lb-ft).

**REMOVAL AND INSTALLATION (Continued)**

2. With the vehicle in NEUTRAL, position it on a hoist. For additional information, refer to Section 100-02.
3. Remove the wheel speed sensor bolt and position the sensor aside.
  - To install, tighten to 15 Nm (11 lb-ft).
4. Remove the brake line bracket bolt and disconnect the wheel speed sensor wire from the bracket.
  - To install, tighten to 20 Nm (15 lb-ft).

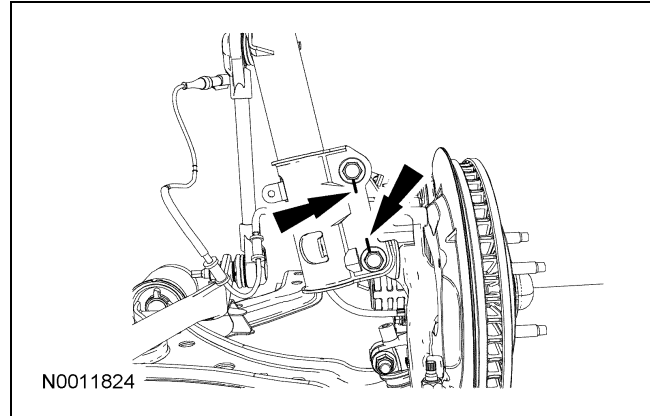
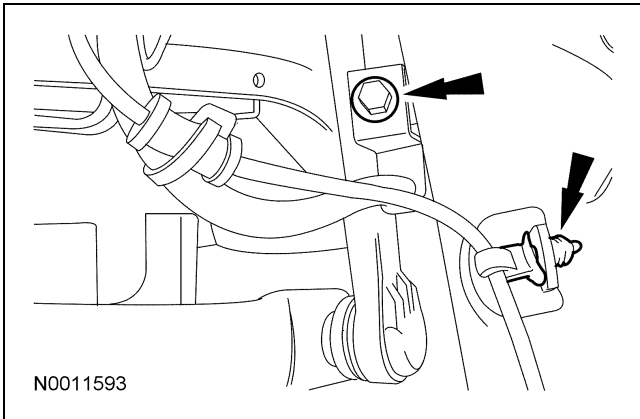

5. **⚠ CAUTION:** Use the holding feature to prevent the studs from turning while removing or installing the stabilizer bar link nuts.  
Remove and discard the stabilizer bar link upper nut and disconnect the link from the strut.
  - To install, tighten to 115 Nm (85 lb-ft).
6. Using a suitable jack stand, support the lower control arm.
7. If equipped, index mark the 2 strut-to-spindle cam bolts.

8. **⚠ WARNING:** All vehicles are equipped with gas-pressurized struts which will extend unassisted. Do not apply heat or flame to the struts during removal or component servicing. Failure to follow these instructions can result in personal injury.

**NOTE:** If equipped, do not discard the strut-to-spindle cam nuts and bolts.

Remove and discard the strut-to-spindle bolts and flag nuts.

- To install, tighten to 200 Nm (148 lb-ft).
9. **⚠ CAUTION:** Damage to the lower control arm bushings may occur if the lower control arm is not supported.  
Carefully lower the lower control arm and remove the strut and spring assembly.
    - To install, the notch and the arrow etched into the upper bearing assembly must face the outboard side of the vehicle.
  10. If necessary, disassemble the strut and spring assembly. For additional information, refer to Strut and Spring Assembly in this section.
  11. To install, reverse the removal procedure.
  12. Check and, if necessary, adjust the front end alignment. For additional information, refer to Section 204-00.