

# REMOVAL AND INSTALLATION

## Steering Column

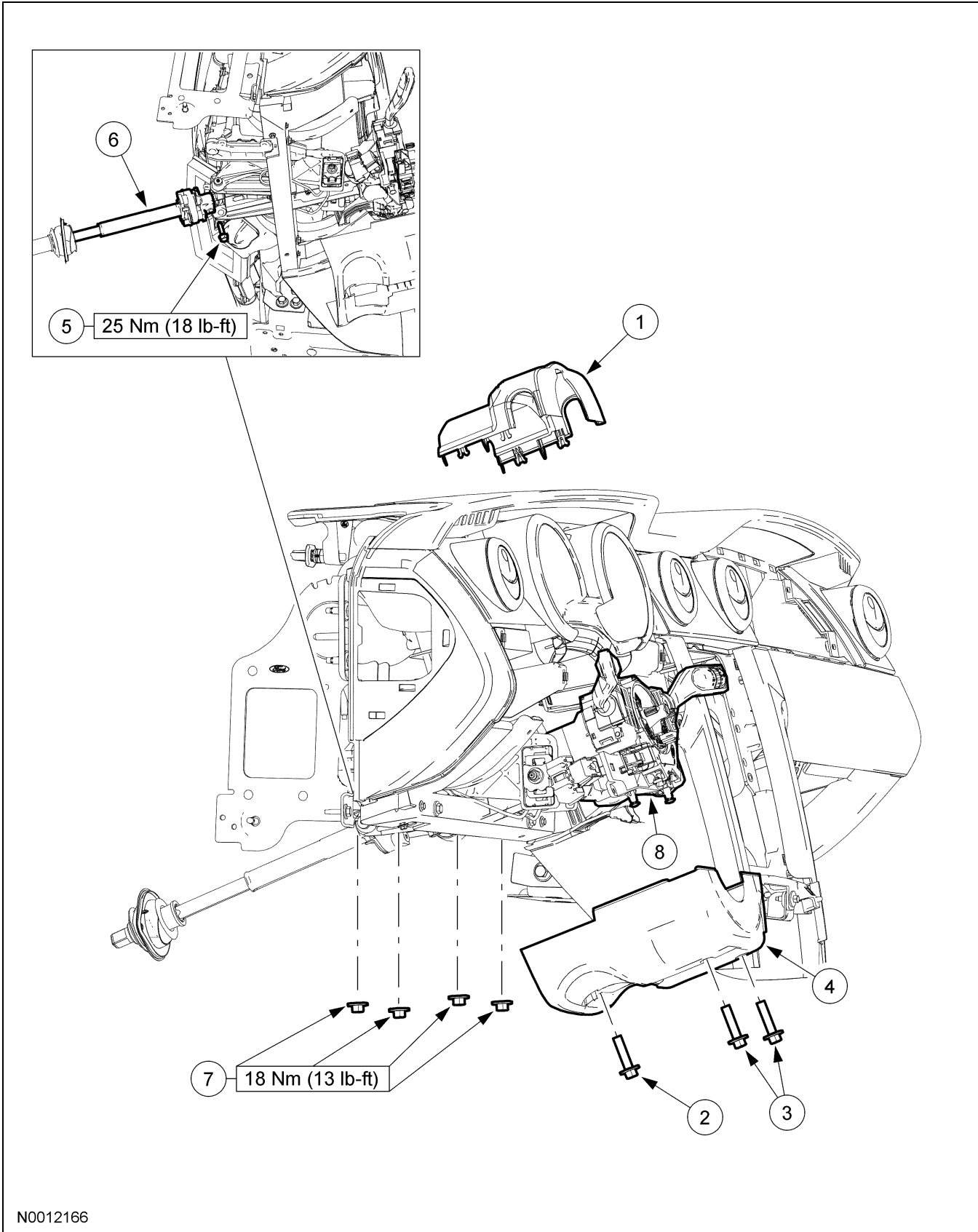

N0012166

**REMOVAL AND INSTALLATION (Continued)**

Item	Part Number	Description
1	3530	Upper steering column shroud
2	W706731-S424	Lower steering column shroud screw
3	W707281-S	Lower steering column shroud screws (2 required)
4	3533	Lower steering column shroud
5	W704980-S436	Steering column shaft-to-steering column bolt
6	3E751	Steering column shaft
7	W705047-S424	Steering column nuts (4 required)
8	3C529	Steering column

**Removal and Installation**

**⚠ CAUTION:** Do not allow the steering column to rotate while the steering column shaft is disconnected or damage to the clockspring can result. If there is evidence that the steering column shaft has rotated the clockspring must be removed and recentered. For additional information, refer to Section 501-20B.

1. Depower the supplemental restraint system (SRS). For additional information, refer to Section 501-20B.
2. Place the steering wheel in the straight-ahead position and remove the ignition key.
3. **NOTE:** The instrument cluster finish panel is held in place with retaining clips that are attached to the bezel.  
Remove the instrument cluster finish panel.
4. Remove the instrument panel center finish panel. For additional information, refer to Section 501-12.
5. Remove the LH A-pillar lower trim panel.

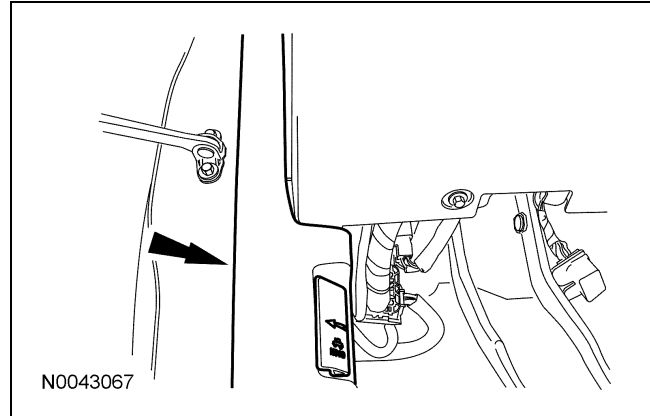

6. Remove the left center stack wing.

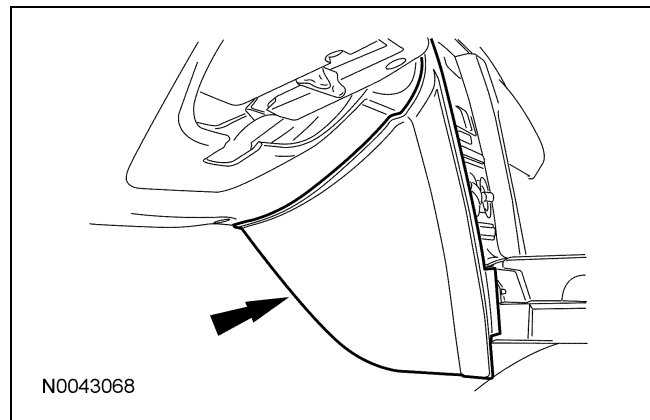

7. Remove the 2 lower instrument panel cover screws and position the lower instrument panel cover aside.

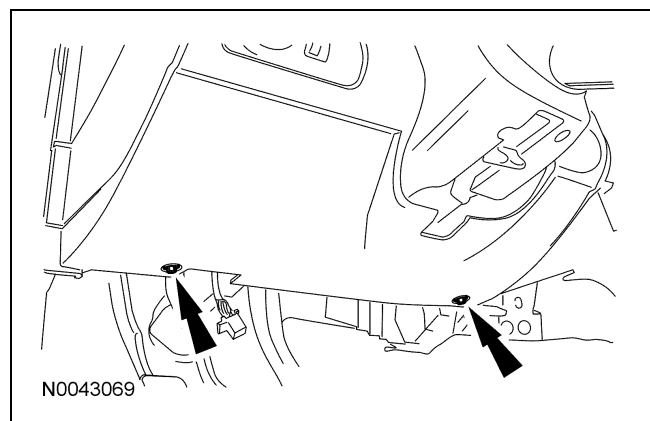

**REMOVAL AND INSTALLATION (Continued)**

8. Disconnect the electrical connectors and remove the lower instrument panel cover.

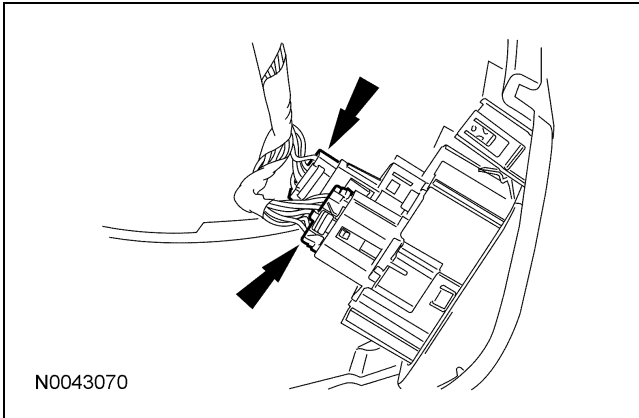

13. Disconnect the ignition switch electrical connector.

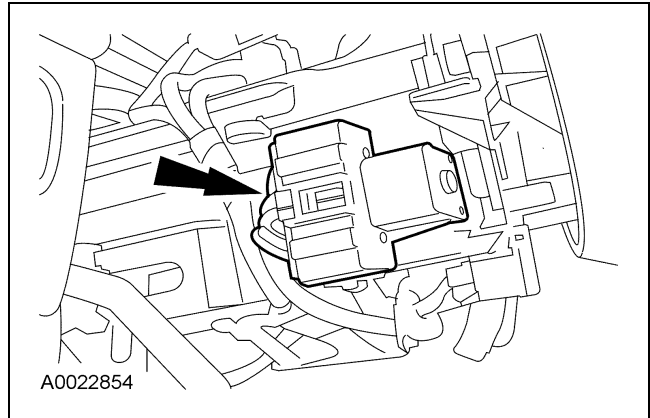

9. Remove the 4 bolts and the instrument panel reinforcement.

- To install, tighten to 9 Nm (80 lb-in).

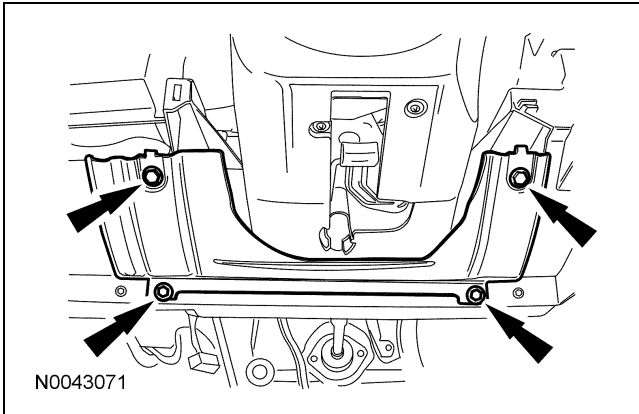

14. Disconnect the wiring harness pin-type retainers.

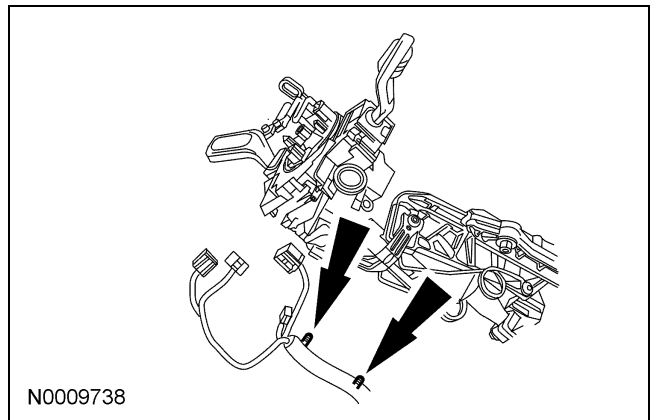

10. Remove the upper steering column shroud by carefully pressing the sides inward.

11. Remove the 3 screws and the lower steering column shroud.

12. Disconnect the 4 electrical connectors.

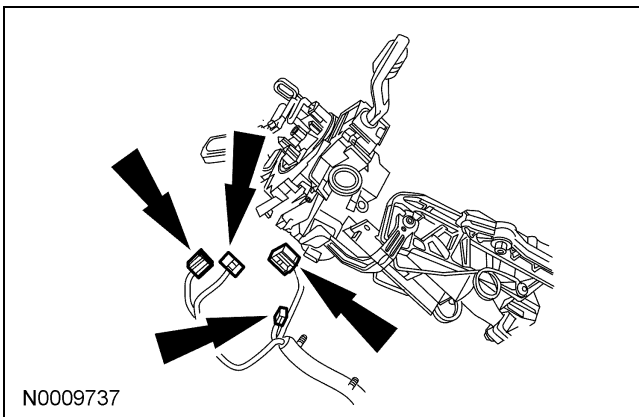

15. Remove and discard the steering column shaft-to-steering column bolt and disconnect the shaft from the steering column.

- To install, tighten to 25 Nm (18 lb-ft).

---

**REMOVAL AND INSTALLATION (Continued)**

16. Remove the 4 nuts and the steering column.
17. To install, reverse the removal procedure.
- To install, tighten to 18 Nm (13 lb-ft).
-